

Following behind the Closing Wheels, our Twisted Drag Chain helps to further crumble and level the soil. This helps even out the rate of drying and ensures the soil does not dry past seed depth.

This is a low cost, low maintenance way to help increase uniform emergence in the drier parts of the field and is a must when using the spading closing wheels in minimum till. By the way, some of our customers still feel the need for some shallow tillage in the spring and the spading closing wheels and drag chain combination do an excellent job in that situation.

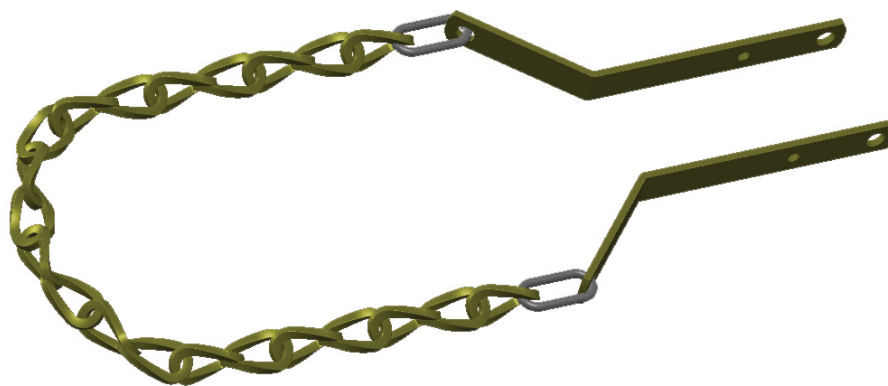

Martin Twisted Drag Chains are designed to follow a pair of 13" spading closing wheels, a pair of 20 point dimple wheels and a single 15" spading closing wheel.



### **DCK-01 Drag Chain Kit**

- Heavy square edge cross chain and brackets
- Bolts to all Max-Emerge units
- Fits Kinze and White units with bolt-on wheels
- Kinze units with roll pin attached closing wheels will need holes drilled for mounting



The Martin Twisted Drag Chain Kit can be seen following a pair of 13” Spading Closing Wheels on a John Deere 1770 planter. Notice in the above photo how the drag chain pulls a handful of soil along which helps smooth and fill in any unclosed areas of the seed slot.

In combination with a pair of RID-01 gauge wheel tires, the seed zone is left slightly elevated to reduced ponding and crusting.