

# **WA 1334**

## **Pin Adjust Row Cleaner with 13" Spiked Wheels**

### **Installation Instructions**

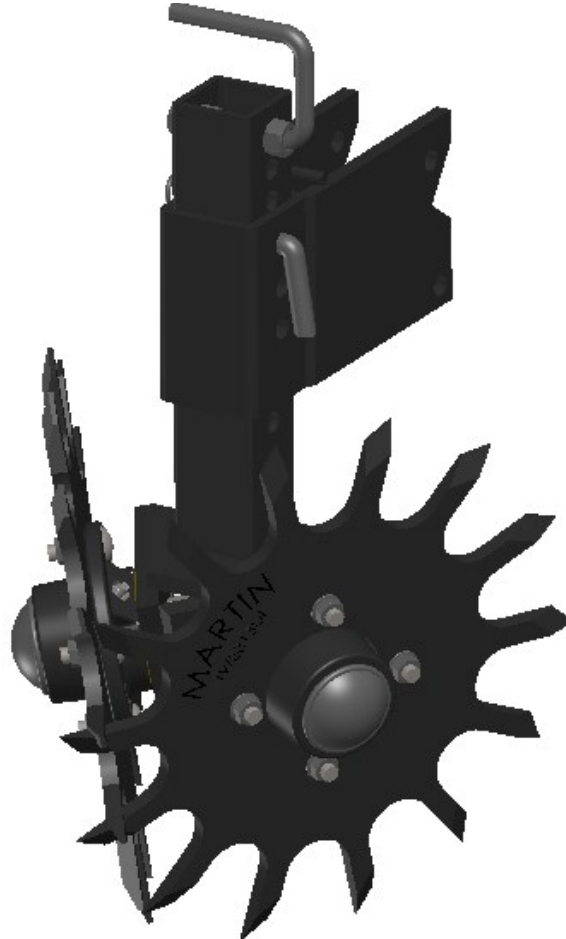

Shown with  
MT892 Mount



### **Martin Planter Attachments**

**Martin Industries LLC**

206 Elk Fork Road

Elkton, KY 42220

Telephone: 270-265-5817

E-Mail: [martin@martintill.com](mailto:martin@martintill.com)

[www.martintill.com](http://www.martintill.com)



**ASSEMBLING THE WHEEL TO THE HUB.**

- 1) Attach the wheels to the Hubs as shown using 3/8" Carriage Bolts and 3/8" Nuts. Tighten. When assembled the part number (TW3813-L4) will be facing away from the hub.
- 2) Repeat process for opposite side.

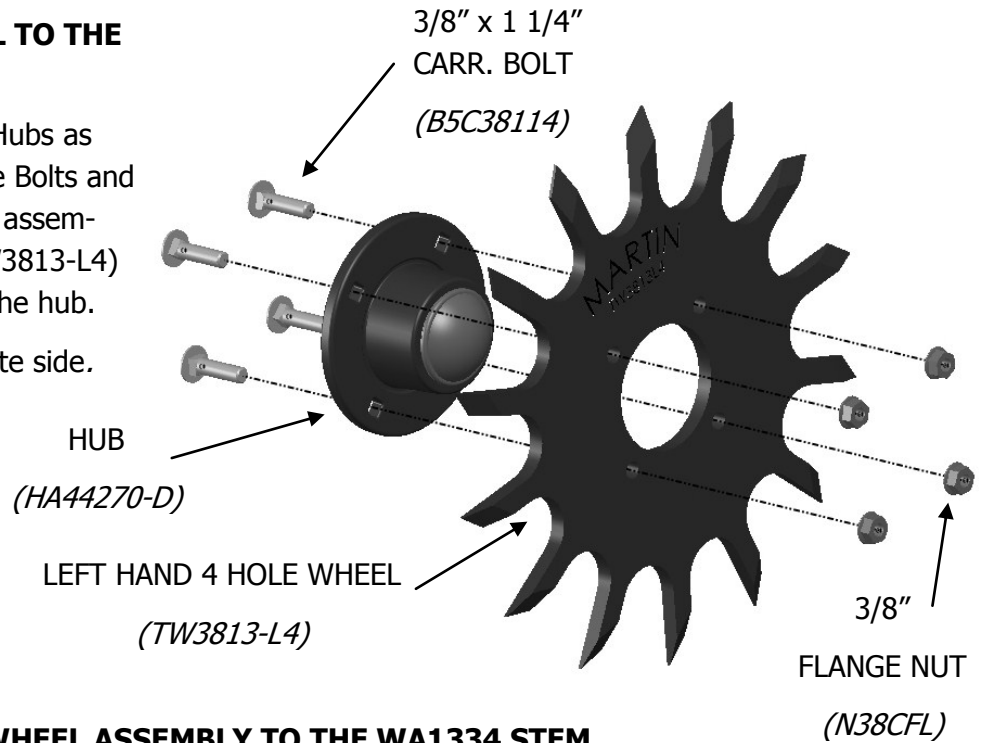

**ATTACHING THE WHEEL ASSEMBLY TO THE WA1334 STEM**

- 1) Place the DLR-01 onto the HA44270-D. Align the flats in the DLR-01 and the HA44270-D axle.
- 2) Place washer up to the hole (refer to page 3 for settings). Push 5/8" X 1 1/2" Patch Bolt through washer and hole.
- 3) Thread 5/8" X 1 1/2" Patch Bolt into the hub assembly. Tighten.
- 4) Torque to 200 ft lbs. Recheck after a days use. Re-torque if needed. Check periodically thereafter.
- 5) The TW3813-L4 hub assembly will bolt up to the left side.
- 6) Repeat process for opposite side (TW3813-R4).

**FRONT VIEW**

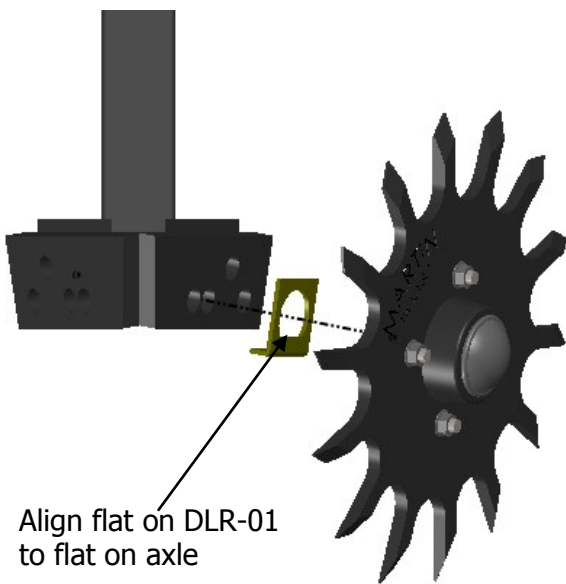

**BACK VIEW**

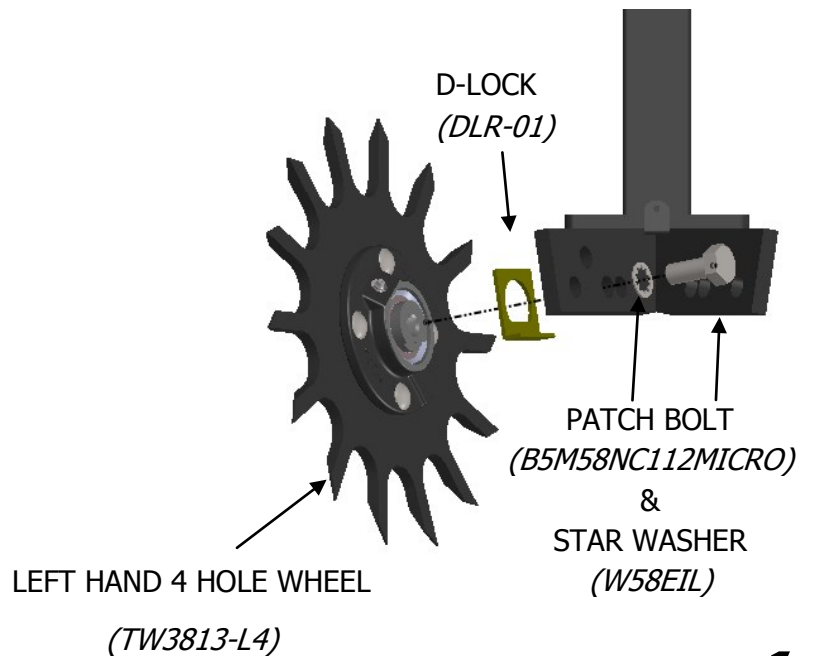

**INSTALLING THE WHEEL ASSEMBLY WITH D-LOCK  
DEFLECTOR (DLD-02) TO THE WA1334**

**OPTIONAL SUPPLIED WITH WA1334 KIT FOR EXTREME TRASHY CONDITIONS**

- 1) Place the DLD-02 on the axle in the hub assembly. Align the flats
- 2) Align the treaded hole in the axle with the hole in the WA1334 stem.
- 3) Place the star washer on the 5/8" x 1 1/2" patch bolt.
- 4) Push the 5/8" x 1 1/2" patch bolt in the hole in the WA1334 stem and thread it into the axle.
- 5) Tighten and torque to 200 ft. lbs. Check after a days use and re-torque if needed.

LEFT HAND 4 HOLE WHEEL

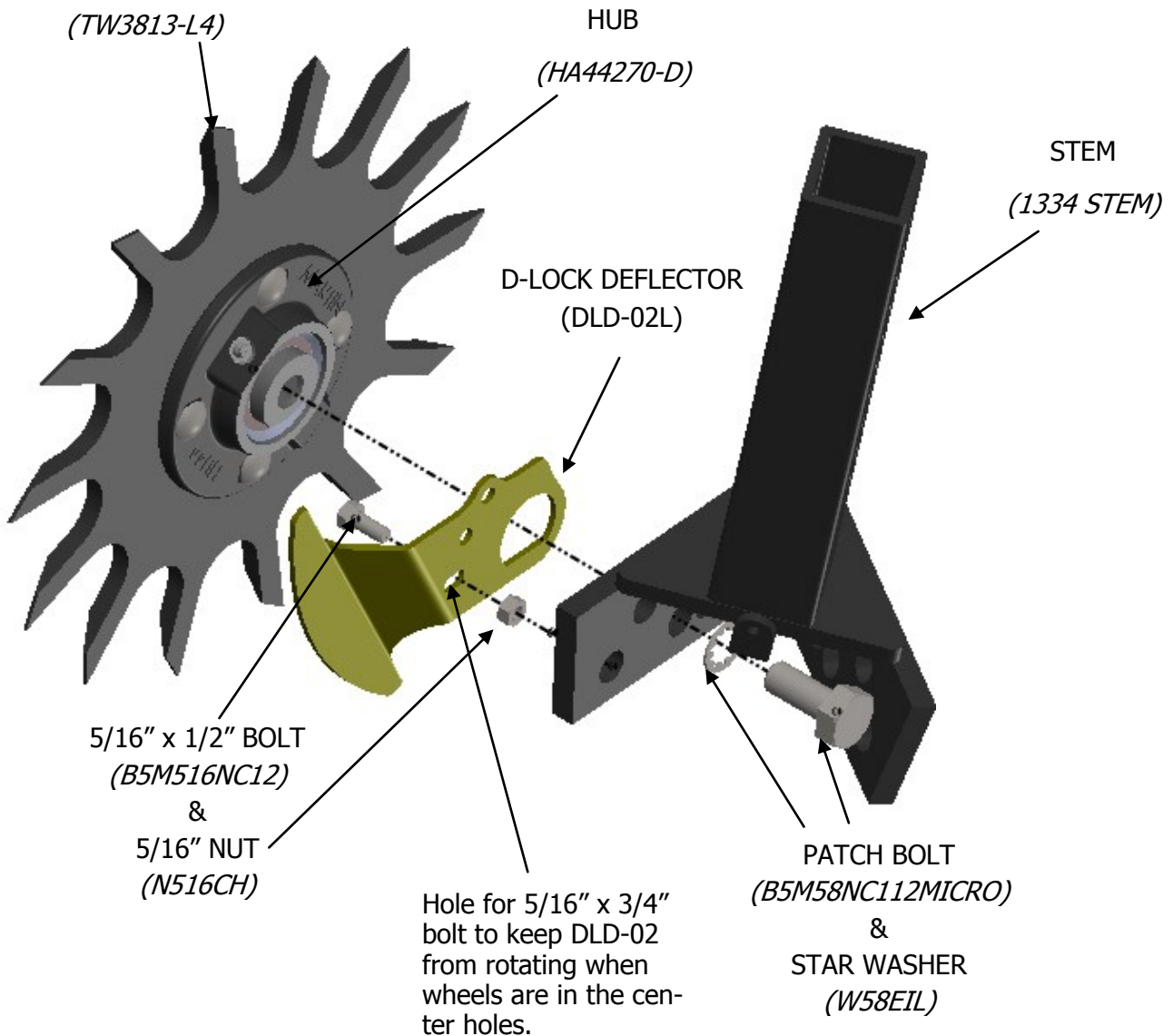

**NOTE: Refer to page 3 for different wheel settings.**

***ATTACHING THE WHEEL WITH D-LOCK DEFLECTOR TO THE  
WA1334 FOR DIFFERENT SOIL CONDITIONS***

**LEFT WHEEL IN REAR HOLE**

**RIGHT WHEEL IN FRONT HOLE**

The staggered configuration allows the toothed wheels to turn more easily in loose soil.

With this staggered configuration, we suggest running the left wheels in the rear hole on the left half of the planter and the right wheels in the rear hole on the right half of the planter (when viewed from behind).

Note: D-Lock deflector bolt fits up against the WA1334, when in the rear hole, not within the 5/8" patch bolt hole.

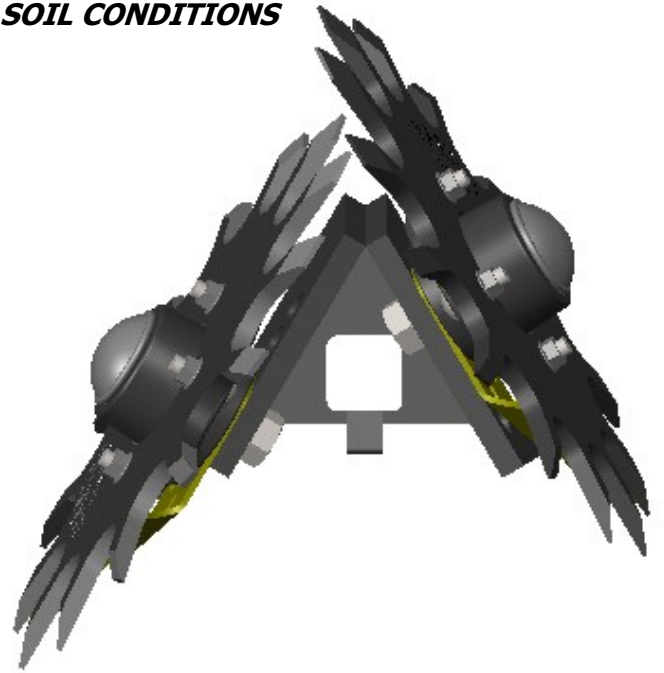

**BOTH WHEELS IN CENTER HOLE**

Both wheels forward provides maximum cleaning effect and the interlocked wheels till the middle of the seed row.

Note: The 5/16" D-Lock deflector bolt fits within the 5/8" patch bolt hole to prevent rotation of the deflector.

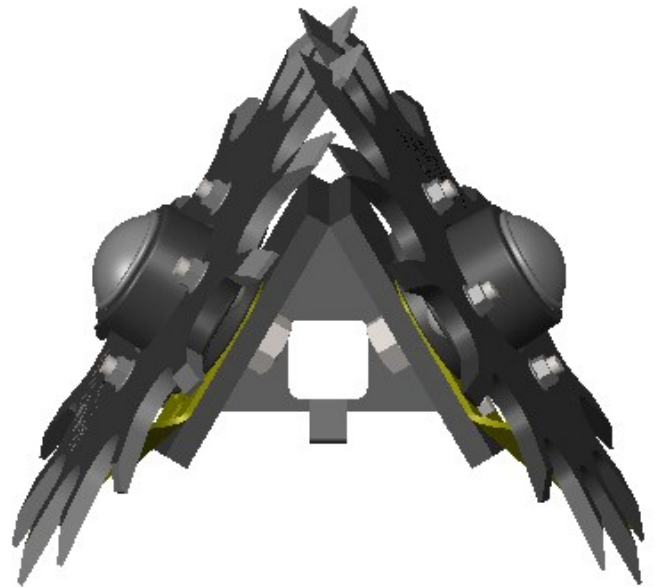

**BOTH WHEELS IN REAR HOLE**

With wheels mounted in the back holes this is a Less aggressive setting. Which leaves residue in center rows.

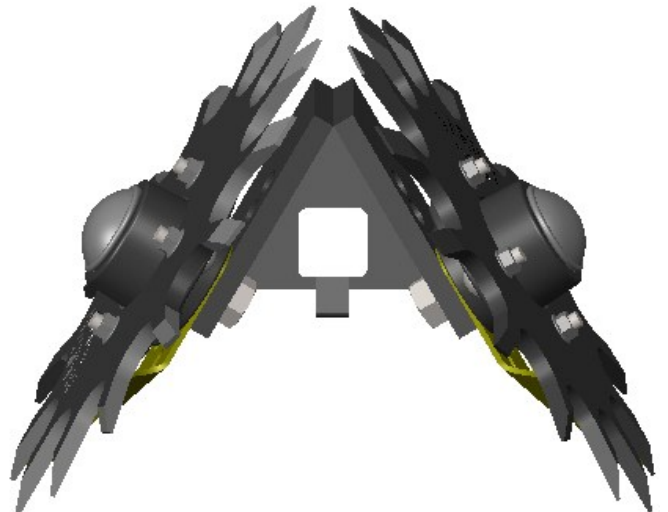

## INSTALLING THE WHEEL ASSEMBLY TO THE MOUNT

- 1) Thread a 1/2" Nut on to the HDL-01 handle.
- 2) Push the WA1334 Stem through the Receiver Tube Mount.
- 3) Push the HDL-01 handle through the top hole in the Stem.
- 4) Add a 1/2" Nut and tighten.
- 5) Hook the 109-0767 Adjustment Assist Spring to the hole in the Tab on the Mount.
- 6) Hook the opposite end of the 109-0767 Adjustment Assist Spring to the hole in the Tab of the Stem.
- 7) Slide the 12B Pull-Pin through the hole in the Stem.
- 8) Insert Safety Pin in the 12B Pull-Pin.
- 9) **RECHECK ALL BOLTS AND TIGHTEN IF NECESSARY.**

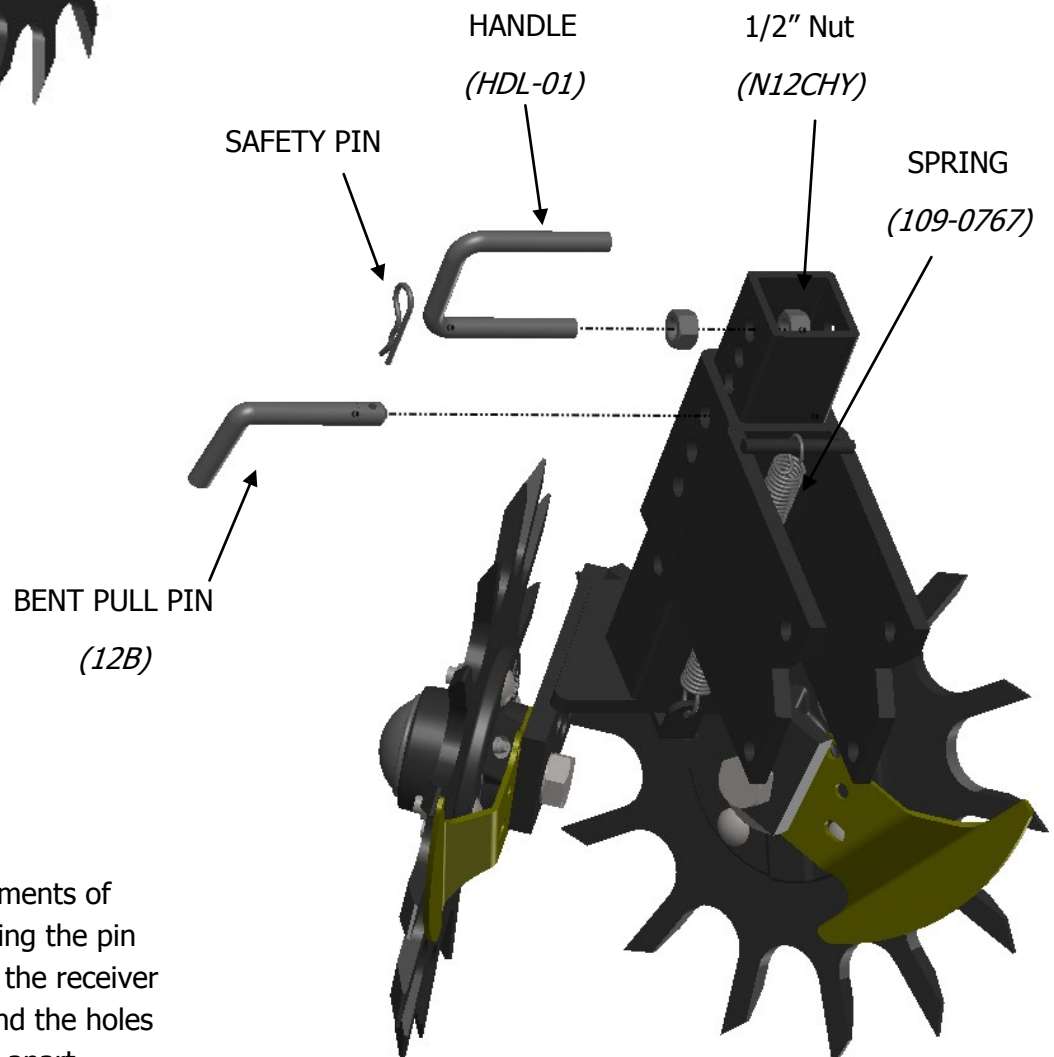
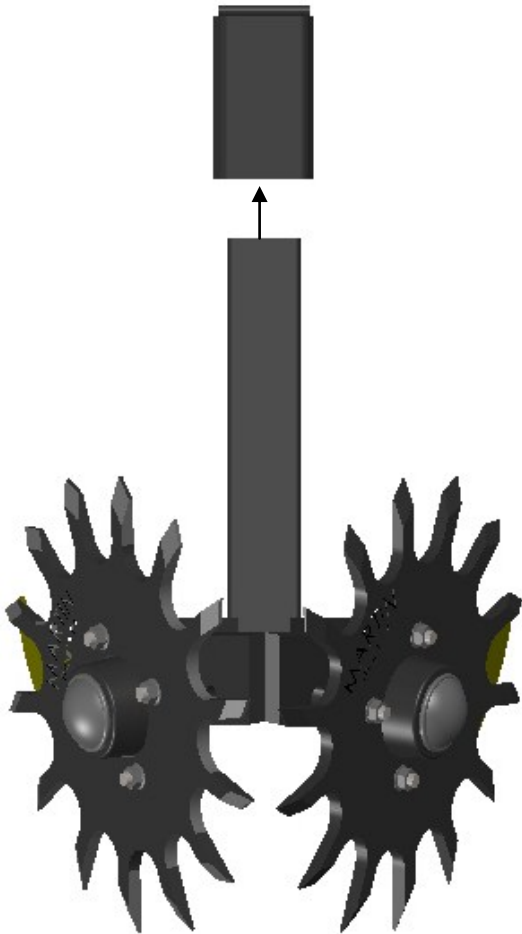

**NOTE:** Adjustment in increments of 1/4" are achieved by installing the pin in one of the three holes in the receiver tube, which are 1" apart, and the holes in the stem, which are 3/4" apart.

**Parts list for HA44270-D**

