

# ***BSCW1544***

**Spading Closing Wheel for 1700 Deere and Kinze  
planters with bolt on hubs**

## **Installation Instructions**

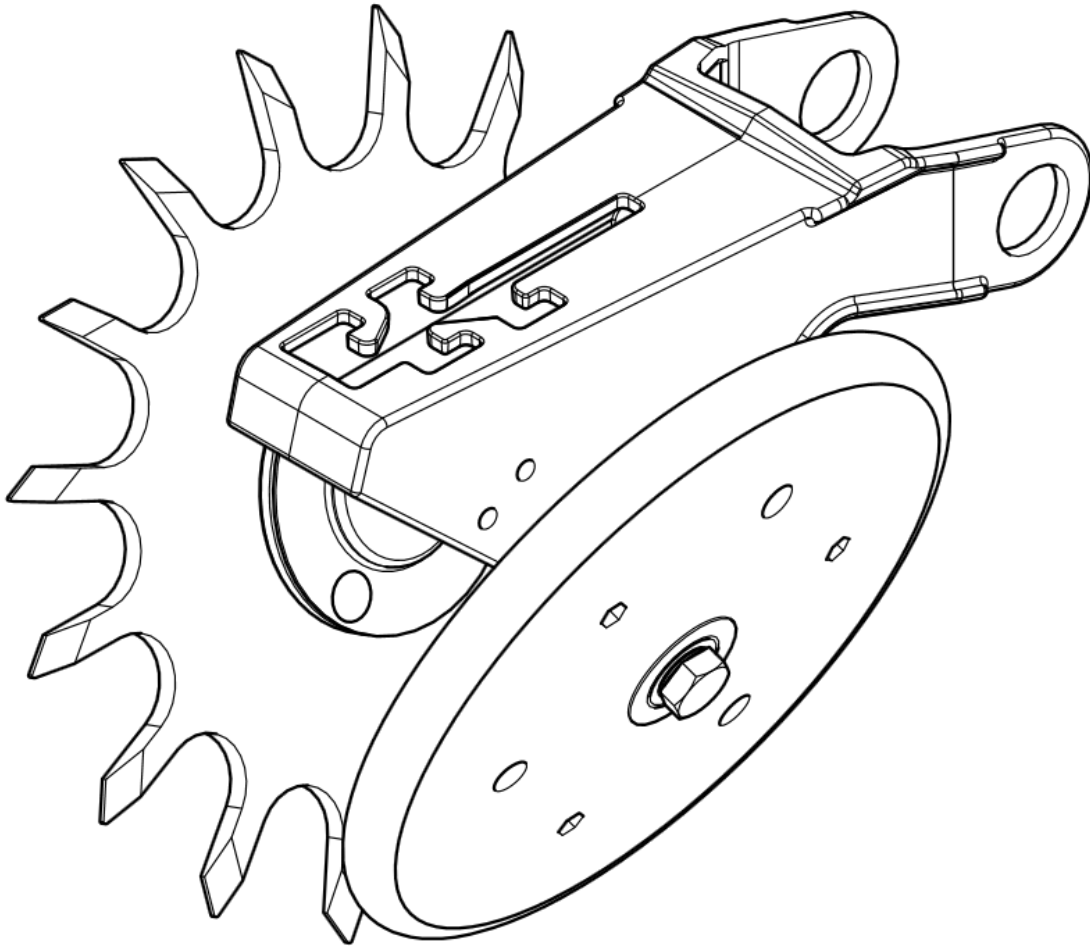

**AFTER-TILL™**

### **Martin Planter Attachments**

**Martin Industries LLC**

206 Elk Fork Road

Elkton, KY 42220

Telephone: 270-265-5817

E-Mail: [martin@martintill.com](mailto:martin@martintill.com)

[www.martintill.com](http://www.martintill.com)



## BSCW1544 ASSEMBLY INSTRUCTIONS

- 1) Place the TW3815-R4 wheel on to the CHU44-B2 hub, with part number facing the hub.
- 2) Align the BC-01 with the holes on the back side of the CHU44-B2 hub.
- 3) Insert the four 3/8" x 1 1/4" carriage bolts then add the four 3/8" flange nuts and tighten.
- 4) Insert the 5/8" x 3 3/4" bolt thru CHU44-B2 hub then add the spacer and washers.

### INSTALLING THE BSCW1544 TO THE TAIL WHEEL HOUSING

- 1) Align the SCW1544 assembly with the hole in the tail wheel housing then insert the 5/8" x 3 3/4" bolt thru the hole.
- 2) Add the 5/8" nut and tighten.
- 3) Recommended distance between TW3815 and the smooth wheel on the opposite side is 2".

NOTE: The TW3815-R4 will be mounted on the left side with the part number facing the furrow. If using the TW3815-L4, it will be mounted on the right side with the part number facing the furrow.

Left and Right is referenced from behind the machine facing the direction of travel.

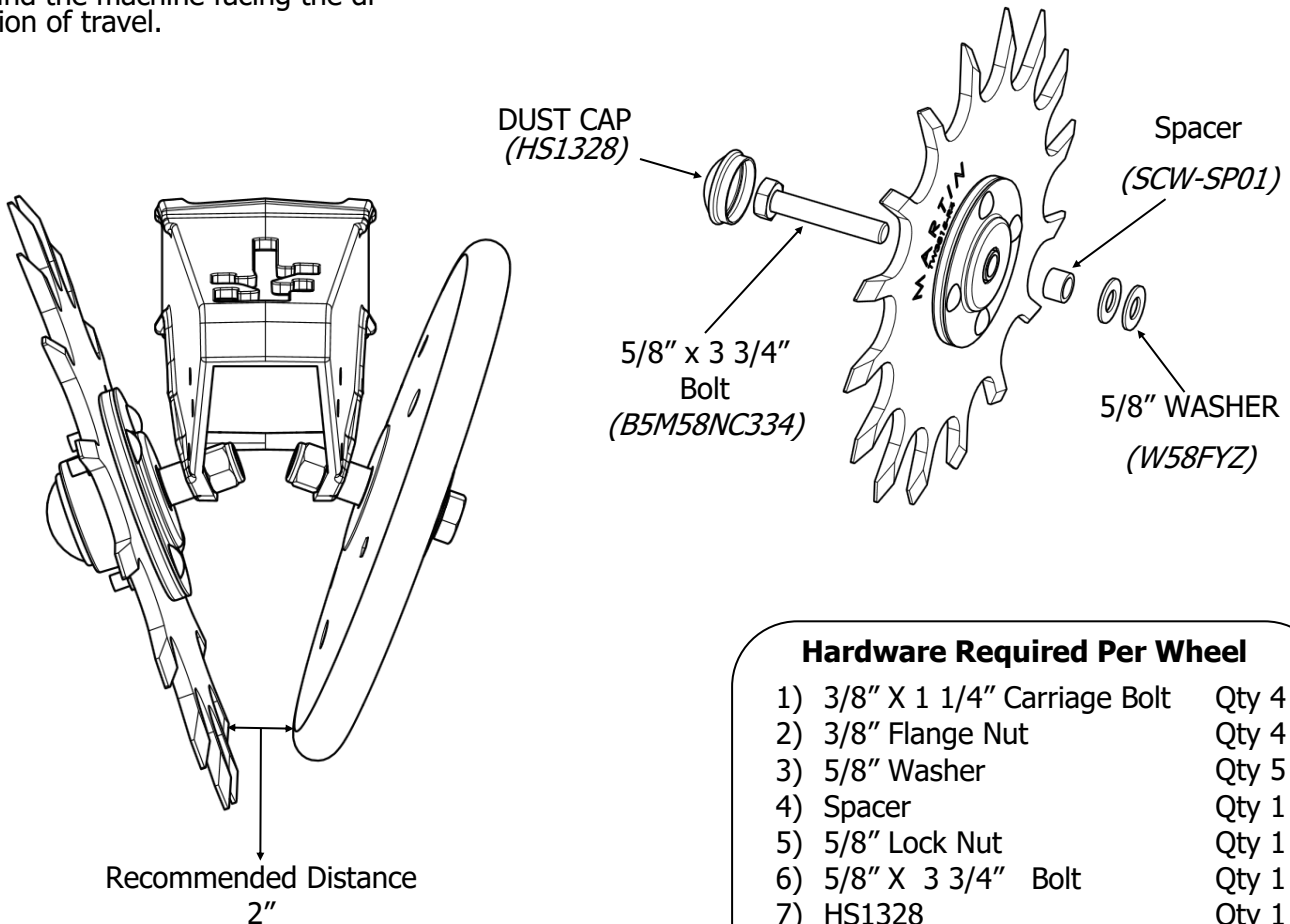
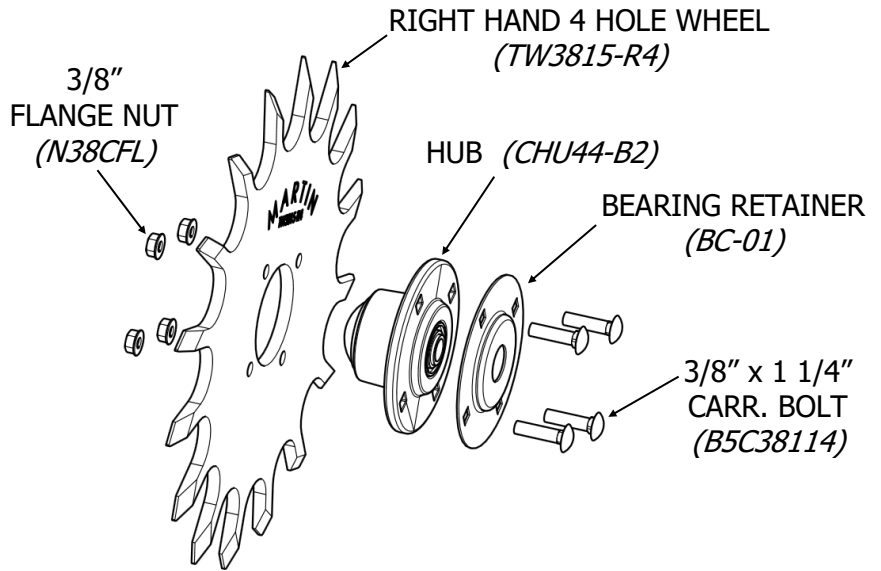

#### Hardware Required Per Wheel

- |                                |       |
|--------------------------------|-------|
| 1) 3/8" X 1 1/4" Carriage Bolt | Qty 4 |
| 2) 3/8" Flange Nut             | Qty 4 |
| 3) 5/8" Washer                 | Qty 5 |
| 4) Spacer                      | Qty 1 |
| 5) 5/8" Lock Nut               | Qty 1 |
| 6) 5/8" X 3 3/4" Bolt          | Qty 1 |
| 7) HS1328                      | Qty 1 |
| 8) BC-01                       | Qty 1 |