

BSCW1543

**Spading Closing Wheel for Deere 7200 and other
planters with axle bolts welded on**

Installation Instructions

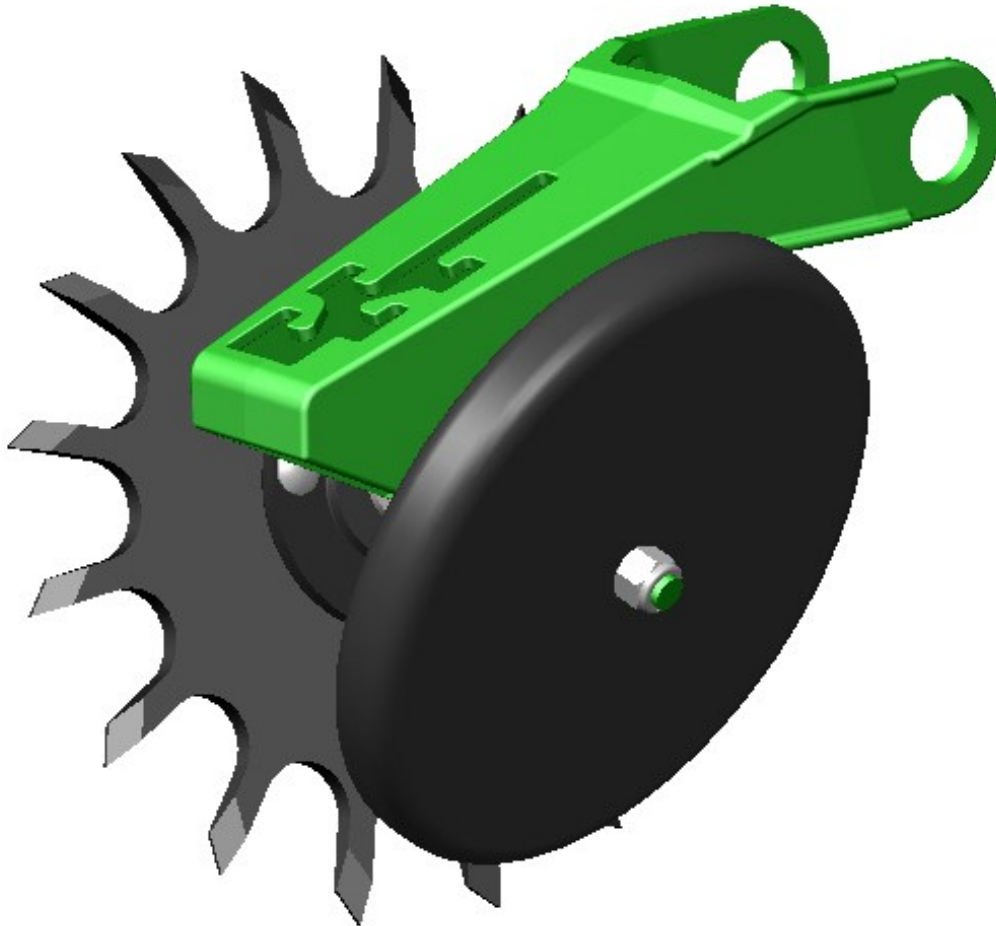

Martin Planter Attachments

Martin Industries LLC

206 Elk Fork Road

Elkton, KY 42220

Telephone: 270-265-5817

E-Mail: martin@martintill.com

www.martintill.com



- 1) Attach the spade wheel to the CHU44-A Hub with the 3/8" x 1 1/4" Carriage Bolts and 3/8" Flange Lock Nuts. The bolts should be inserted through the hub first, then through the wheel, with the part number on the wheel facing the hub.
- 2) Remove the smooth closing wheel with bearing from the planter.
- 3) Place as many 5/8" flat washers as needed for correct spacing on existing closing wheel arm stud.
- 4) Install replacement hub on the axle, with part number on wheel facing furrow. Do not place any flat washers on hub side that is away from furrow.
- 5) After achieving the correct spacing, secure hub with existing 17mm nut and install dust cap.

Note:

Wheel with part number ending with **R4** should be installed on the left side with part number facing the furrow. Repeat for right side using wheel with part number ending with **L4**. This applies to all closing wheels and is the opposite side from which the wheels are used for row cleaners.

To move spaded closing wheel further away from the furrow on JD7200 planters, it may be necessary to place washers on the bolts between the hub and the wheel.

Left and Right is referenced from behind the machine facing the direction of travel.

RIGHT HAND 4 HOLE WHEEL

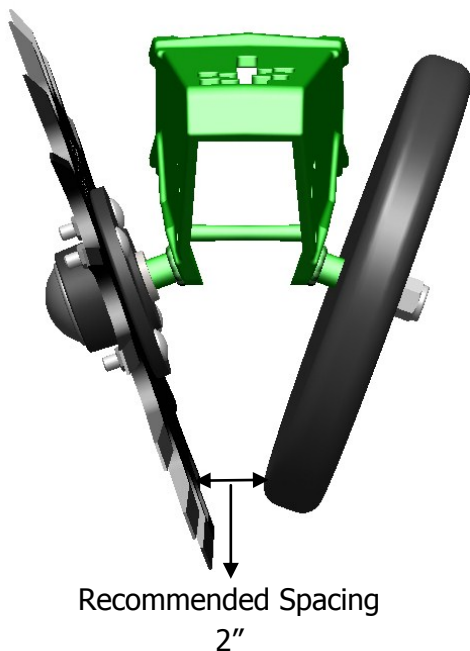
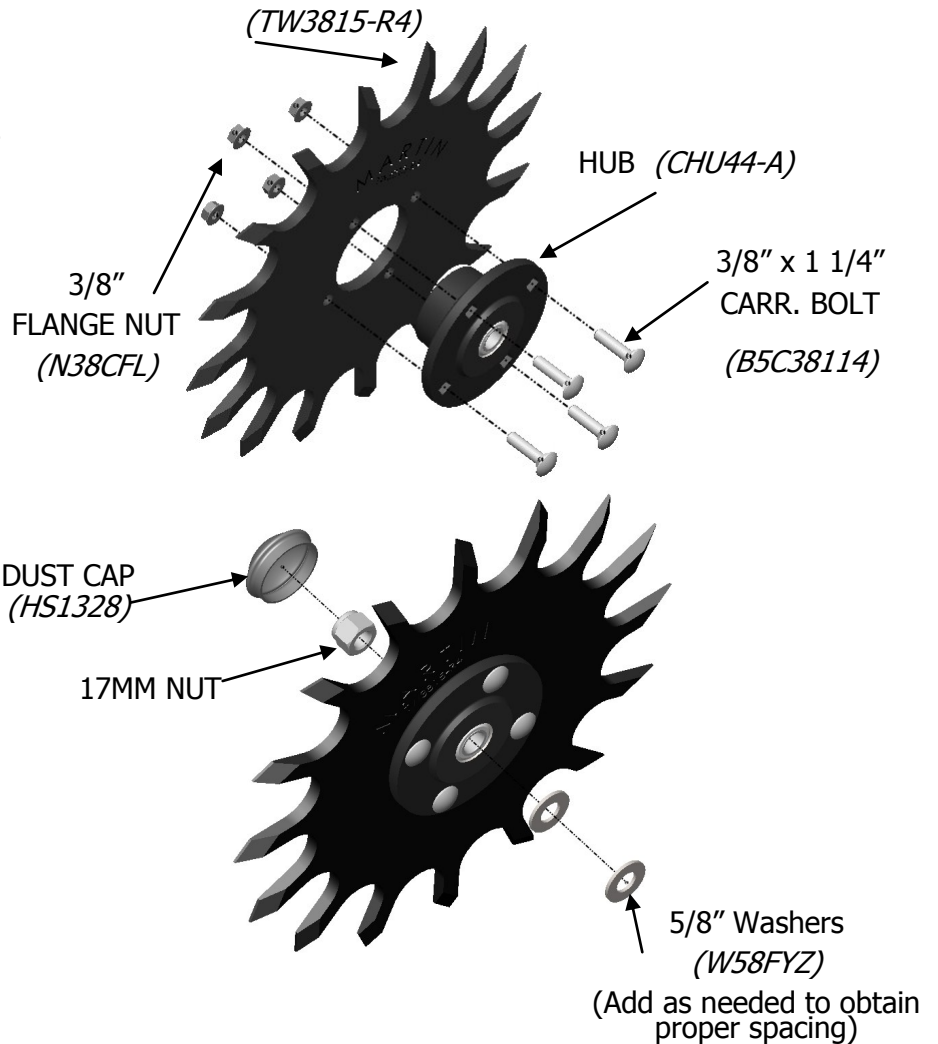

Hardware Required Per Wheel

1) CHU44-A Hub	Qty 1
2) A70 Axle	Qty 1
3) 5/8" Flat Washer	Qty 4
4) 5/8" Thin Nyloc Nut	Qty 1
5) 3/8" x 1 1/4" Carriage Bolt	Qty 4
6) 3/8" Flange Lock Nut	Qty 4
7) HS1328	Qty 1